

## #MGS - Mortar/Grout Screen

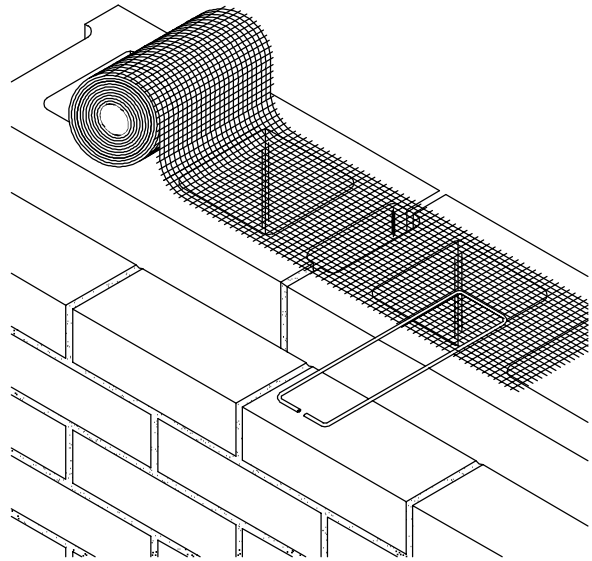
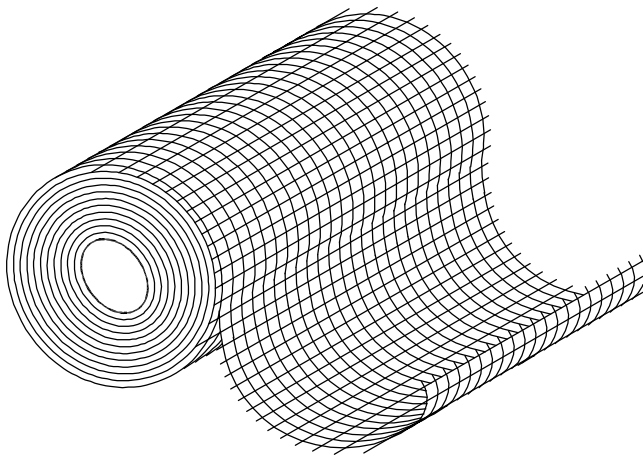

DRAWINGS FOR ILLUSTRATIVE PURPOSES ONLY

**FEATURES:**

- Isolates flow of grout in designated areas requiring reinforced concrete block.
- Allows for greater bonding of masonry anchor in hollow block construction.
- 1/4" square monofilament screen is fabricated from high strength, non-corrosive polypropylene polymers.
- Micro-thin material has high tensile and burst strength, yet will not interfere with mortar bond.

**SIZE:**

- 4" WIDE (FOR 6" BLOCK)
- 6" WIDE (FOR 8" BLOCK)
- 8" WIDE (FOR 10" BLOCK)
- 10" WIDE (FOR 12" BLOCK)

**NOTE:**

- Length per roll is 100 ft.



Hohmann & Barnard, Inc.  
30 Rasons Court  
Hauppauge, New York 11788  
TEL: (800) 645-0616 FAX: (631) 234-0683

WEBSITE: [www.h-b.com](http://www.h-b.com)  
E-MAIL: [weanchor@h-b.com](mailto:weanchor@h-b.com)

© HOHMANN & BARNARD, INC. - 1999