

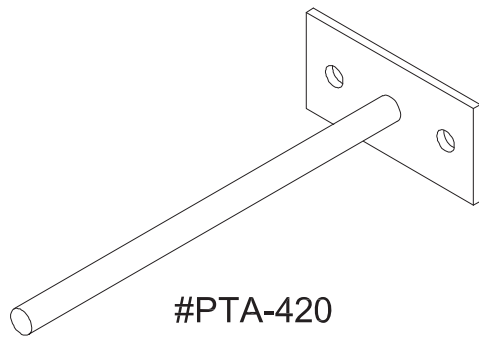

HPTA Series Partition Top Anchors

04082/HOH
BuyLine 1823

#PTA-420



#PTA-420

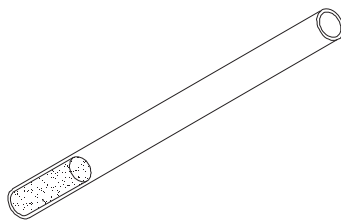

PTA TUBE
(W / Compressible Filler)

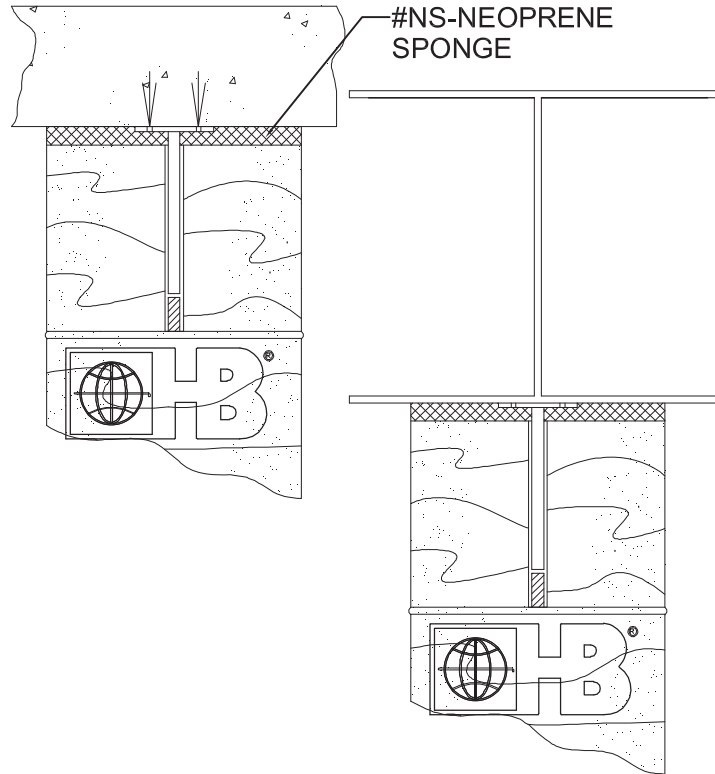

DRAWINGS FOR ILLUSTRATIVE PURPOSES ONLY

SHEET METAL (Carbon Steel):

ASTM A 366/A 366M (Cold-rolled)
ASTM A 569 (Hot-rolled, pickled and oiled)

FINISHES - SHEET METAL (Carbon Steel):

Mill Galvanized - ASTM A 653 Coating Designation G60
Hot-Dip Galvanized - ASTM A 153 Class B (sheet metal ties and anchors hot-dip galvanized after fabrication)

Note: Hohmann & Barnard will certify to a minimum zinc coating of 2.0 oz./ft.²

SHEET METAL (Stainless Steel):

ASTM A 167 - AISI Type 304 Stainless Steel (sheet metal ties and anchors) (Type 316 available on special order)
Note: H&B recommends Stainless Steel for maximum protection against corrosion.

ROD:

Zinc Plated - ASTM A 108, A 36, B 633
Hot-Dip Galvanized - ASTM A 153
Stainless Steel Type 304 - ASTM A 582

PTA TUBE:

Manufactured from Clear Butyrate. Tested in conformance with ASTM D 542, D 149, D 696 and D 257.

FINISHES:

- Mill galvanized
- Hot-dip galvanized
- Stainless Steel

NOTE: #NS-Neoprene Sponge also available. Submittal sheet available on request.

We Anchor The World



Hohmann & Barnard, Inc.
30 Rasons Court
Hauppauge, New York 11788
TEL: (800) 645-0616 FAX: (631) 234-0683

WEBSITE: www.h-b.com
E-MAIL: weanchor@h-b.com

©HOHMANN & BARNARD, INC. - 1999