

X-SEAL[®] TAPE

Self-sealing - Seals around shaft of screw and legs of X-SEAL[®] Anchor at the moment of penetration.

Durable - Resilient, will not crack or rot.

Ease of installation - Adhesive-backed 40-mil rolls 3"x 50 ft. Apply to clean, dry surface.

Now manufactured from 45% recycled material.

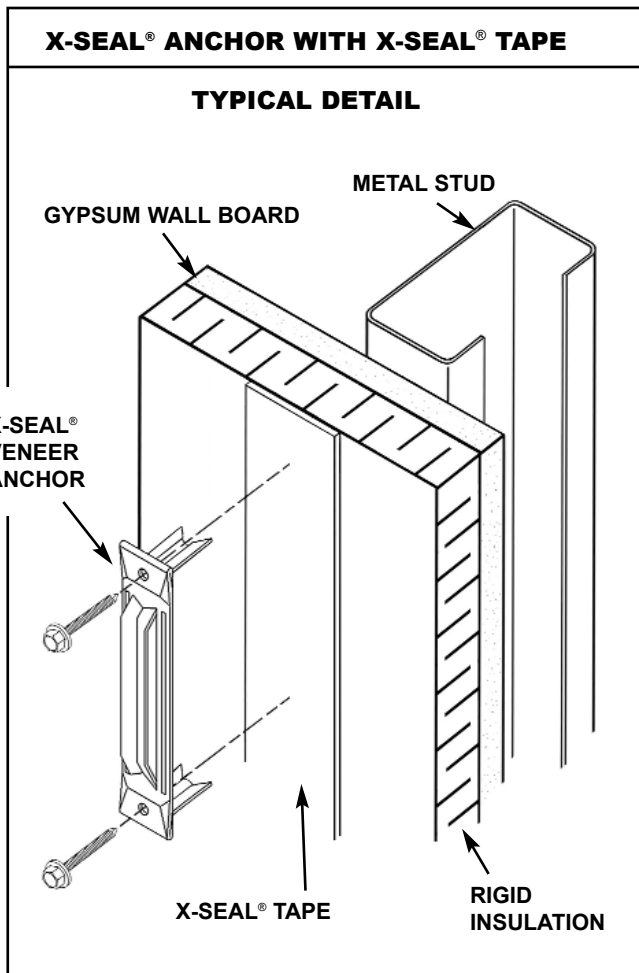

Patents Pending

Physical Properties Chart			
	Minimum	Target	Maximum
Basis Weight (T-410)		87 lbs 142 g/m ²	
Spunbond	50 lbs	55 lbs 89 g/m ²	60 lbs
Poly	30 lbs	32 lbs 52 g/m ²	34 lbs
Slide Angle	26°F	28°F	32°F

Installation:

X-SEAL[®] TAPE should be applied in continuous lengths. Surface must be dry and free of oils, dirt, dust, loose rust scales or any other materials which might cause poor adhesion. Continuous lengths are recommended to facilitate maximum adhesion.

For correct application of X-SEAL[®] TAPE, start from the bottom of the wall and work upward. Roll on with an evenly distributed pressure applied via 3" roller.

Storage and protection:

As recommended by manufacturer, store X-SEAL[®] TAPE at a temperature between 60°F (15.5°C) and 80°F (26.6°C). If exposed to lower temperatures, restore product to 60°F (15.5°C) minimum temperature before application.

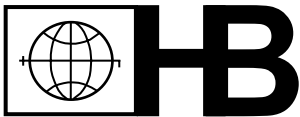

Hohmann & Barnard, Inc.
30 Rasons Court
Hauppauge, New York 11788
Tel: 800/645-0616 Fax: 631/234-0683

Website: <http://www.h-b.com>
E-Mail: weanchor@h-b.com

© Hohmann & Barnard, Inc. - 2004